

MAXIAL QUICK SETUP GUIDE (80-25-1)

ACCESSORIES REQUIRED IN THIS ASSEMBLY

- STD TRACK SECTIONS 9'-9" (90-2)
 - UNIFORM CARRIAGE (200-1)
 - BASE FEET (80-1)
- KWIK BOLTS (90-6)
 - SCAFF CLAMPS (90-4)
 - SLIDING HEAD (80-2)
- MAXIAL CONTROLLER (30-40-1)
 - PENDANT (50-35)
 - BASKET (200-3, 100-2, 100-3. OR 100-4)
- BOTTOM STOP (80-4)
 - TOP STOP (80-8)

1



X 1

TRACK SECTIONS 9'9"

X 1

STD UNIVERSAL CARRIAGE (200-1)

X 2

BASE FEET (80-1)

X 2

KWIK BOLT (90-6)

INSTALL BASE FEET AND KWIK BOLTS

INSTALL CARRIAGE FROM TOP

BUMPERS

RUNGS CLOSER TO GROUND

BRAKE RELEASE

TAB

TOP

WHEN INSTALLING THE KWIK BOLT THERE IS NO NEED TO REMOVE THE WING NUT AND WASHER. PUSH KWIK BOLT THROUGH AND TURN 90 DEGREES. TIGHTEN WING NUT.

2

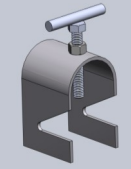

X 4

SCAFF CLAMPS (90-4)

SCAFFOLDING

SCAFFOLDING

X 2

X 2

SCAFFOLDING

SCAFFOLDING

WARNING! SCAFF CLAMP MAX. SPACING IS 6'-6" (78")

SLIDE SCAFF CLAMPS IN PLACE AND TIGHTEN.

3

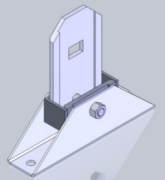

X 1

STD. SLIDING HEAD (80-2)

INSTALL SLIDING HEAD INTO FRONT SIDE OF CHANNEL WITH PULLEY FACING TO THE FRONT. PULL FLIPPER HANDLE TO GET PAST RUNGS.

GROOVES

FLIPPER HANDLE

4

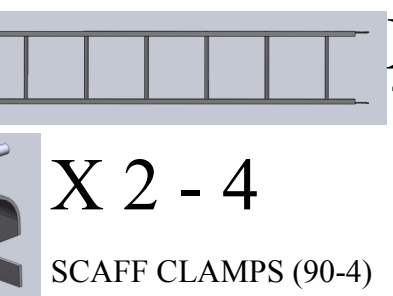

X 1

TRACK SECTIONS 9'9"

X 2 - 4

SCAFF CLAMPS (90-4)

X 2 - 4

KWIK BOLT (90-6)

4A SLIDE TRACK ON

4B INSTALL KWIK BOLTS AS IN #1

4C ADD SCAFF CLAMPS AS IN #2. MAX 6'-6" (78")

RUNGS TOWARDS BACK

SCAFFOLD

KWIK BOLTS

WARNING! SCAFF CLAMP MAX. SPACING IS 6'-6" (78")

5

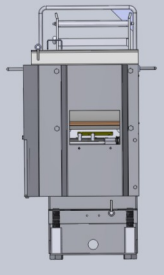

X 1

MAXIAL HOISTING MOTOR (80-25-1)

5A - MOVE SLIDING HEAD AND CARRIAGE UP TO SECOND TRACK.

5B - INSTALL MOTOR FROM THE FRONT OF THE ASSEMBLY ON THE 2ND AND 3RD RUNGS. THERE ARE SPRING FLIPPERS FOR THE TOP AND BOTTOM RUNGS.

FLIPPER

FLIPPER

FRONT

BACK

6

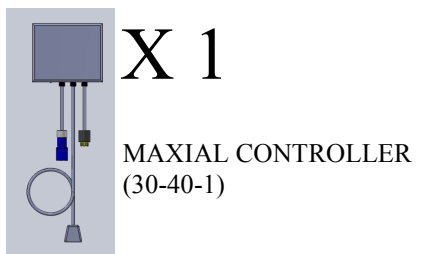

X 1

MAXIAL CONTROLLER (30-40-1)

X 1

PENDANT (50-35)

HANG MAXIAL CONTROLLER BY THE PIPE CLAMP. CONNECT THE BLUE CONTROLLER PLUG TO THE PENDANT, THE GRAY CONTROLLER PLUG TO THE MOTOR (BACK), AND THE POWER CORD TO THE CORRECT POWER SOURCE.

OVER

102913-R1

MAXIAL TRACK HOIST SYSTEM (80-25-1)

QUICK START GUIDE



Please read the Beta Max Maxial Track Hoist manual. The manual contains important safety information which must be understood by any operator. This Quick Start Guide does not replace the manual. It only serves as a guide for installation.

NOTE: ANY TRACK SECTION THAT HAS DAMAGED RUNGS, INCLUDING CREASES OR BENDS, SHOULD BE DISCARDED.

7

7A - VERIFY CONTROL BOX LED (BOTTOM OF CONTROL BOX) IS ILLUMINATED.

7B - KEEPING THE CABLE TIGHT. PUSH THE DOWN BUTTON ON THE CONTROLLER AND SPOOL OUT ABOUT 15' OF CABLE

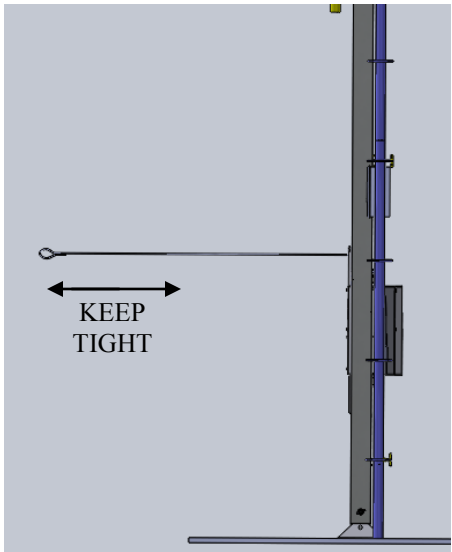

NOTE: IN ALL "NO LOAD" SPOOLING SITUATIONS ALWAYS KEEP PRESSURE ON THE ROPE TO AVOID DAMAGE

WARNING!
DO NOT DEFEAT OR DISABLE ANY SAFETY FEATURE

8

8A - GUIDE WIRE ROPE BETWEEN CARRIAGE AND TRACK, AROUND PULLEY AND DOWN TO CARRIAGE LUG. DO NOT ATTACH WIRE ROPE YET.

8B - SPOOL EXCESS WIRE ROPE BACK INTO HOIST SO THERE IS JUST ENOUGH TO CONNECT TO THE CARRIAGE. KEEP WIRE ROPE TIGHT WHILE SPOOLING.

8C - ATTACH WIRE ROPE TO CARRIAGE LUG BY PROVIDED SHACKLE.

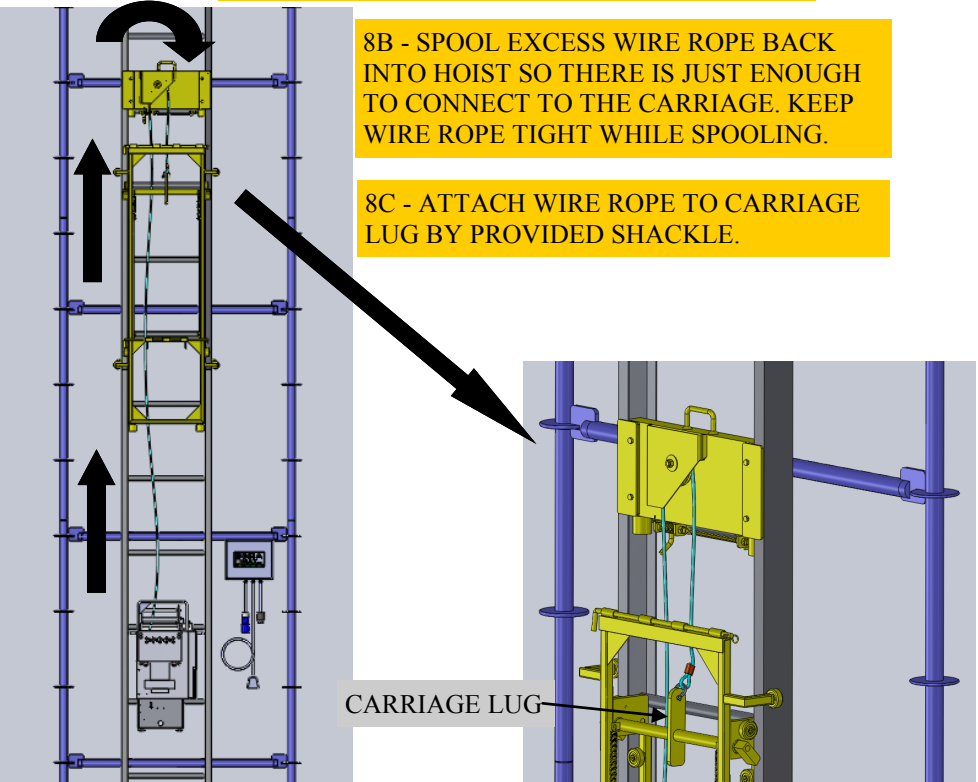

9

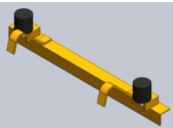

X 1

BOTTOM STOP (80-4)

9A—LOWER CARRIAGE BY FIRST RAISING THE CARRIAGE TO RELEASE THE BRAKE. NOTE WEIGHT MAY BE REQUIRED ON THE CARRIAGE TO KEEP THE BRAKE FROM ENGAGING IN THE DOWN DIRECTION.

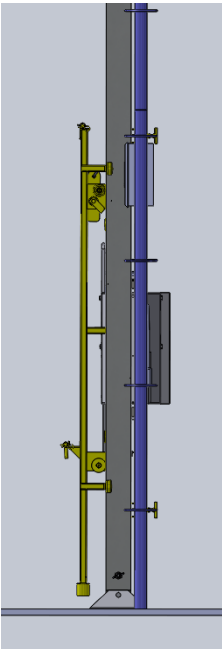

9B - INSTALL BASKET ON CARRIAGE BY THE TWO PINS. BE SURE TO RE-INSTALL CLEVIS PINS.

THE BOTTOM STOP ENABLES THE HOIST TO BE STOPPED AT A PREDETERMINED LOCATION BETWEEN THE GROUND AND THE SLIDING HEAD.

9C - (OPTIONAL) INSTALL BOTTOM STOP BY HANGING IT FROM A RUNG AT THE DESIRED LEVEL (ABOVE BOTTOM)
NOTE: NO BOTTOM STOP REQUIRED AT BOTTOM.

10

MOVING UP

WARNING! SLIDING HEADS SHOULD NEVER BE MOUNTED ON THE TOP RUNG OF ANY LADDER

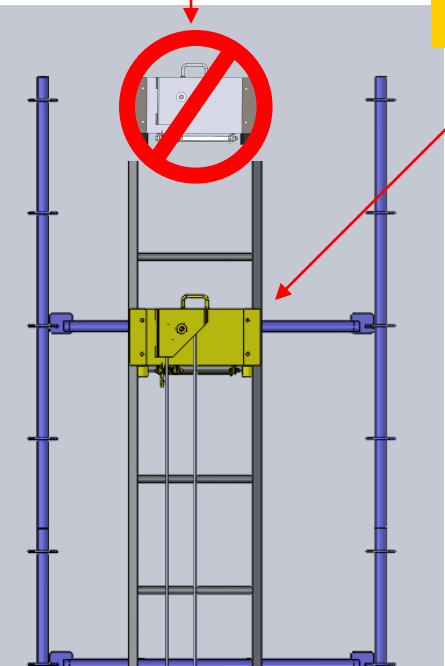

10A - MOVE SLIDING HEAD UP EVEN WITH HIGHEST SCAFF CLAMP.
10B - LOAD AND RUN SCAFFOLDING AS REQUIRED UNTIL READY TO EXTEND MAXIAL TRACK.
10C - LOAD 1-2 MORE SECTIONS OF TRACK AND RUN UP TO WORKING LEVEL.
10D - FOLLOW STEPS 4 & 10 UNTIL TOP LEVEL IS REACHED.

WARNING!
DO NOT BRING SLIDING HEAD ABOVE HIGHEST SCAFF CLAMP

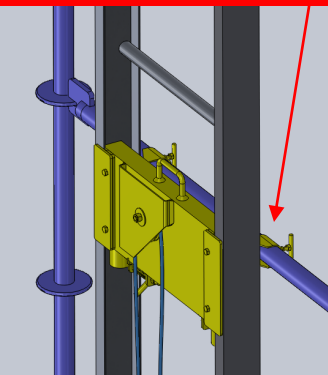

WARNING! DO NOT RUN SLIDING HEAD ON ANY UNSUPPORTED TRACK SECTIONS

11

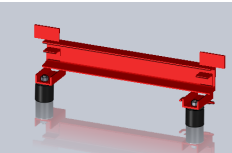

X 1

TOP STOP (80-8)

THE TOP STOP ENABLES THE HOIST TO BE STOPPED AT A PREDETERMINED LOCATION BETWEEN THE GROUND AND THE SLIDING HEAD

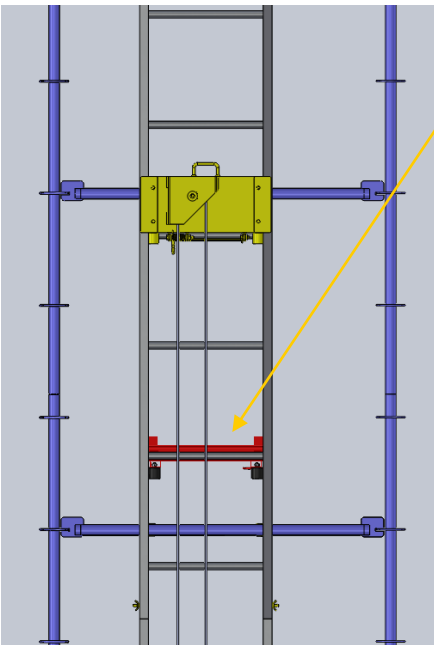

INSTALL TOP STOP AT DESIRED STOPPING LEVEL. TOP STOP INSTALLS FROM THE BACK. BE SURE AND SECURE THE TOP STOP BY ENGAGING THE LATCH ON THE BOTTOM OF THE STOP.

